

IQOS
ILUMA

O N E

User Guide

IQOS ILUMA ONE™

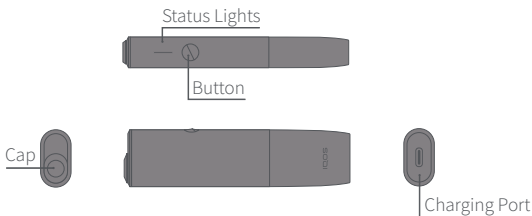

Charging

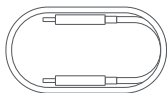

Charging Cable

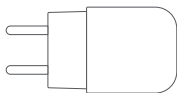

Power Adaptor

IQOS ILUMA™ is compatible only with SMARTCORE STICKS™

SUPPORT AND SERVICES

For information on customer support and additional services for IQOS users, please visit

www.iqos.com/services

FEATURES AND SETTINGS

You can modify your IQOS experience according to your preferences with the IQOS App*.

Please register by scanning QR code or log in on www.iqos.com/iluma and follow the instructions.

* IQOS app may not be available in your country.

Getting Started

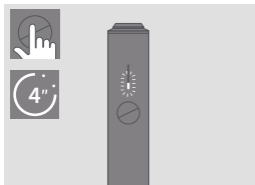

TURN ON

Press and hold Button for 4 seconds, then release; Status Lights will turn on slowly.

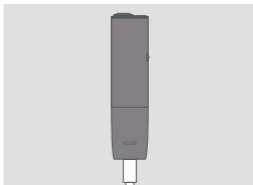

CHARGE

Before first use, fully charge your IQOS ILUMA ONE™ with Power Adaptor and Charging Cable.
(approx. 90 min)

How to use your IQOS ILUMA ONE™

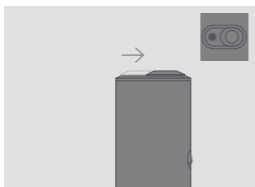

OPEN

Slide to open.

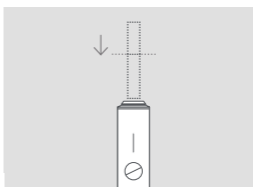

1. INSERT SMARTCORE STICK™

Insert the SMARTCORE STICK™ to the line on filter with filter facing outside.

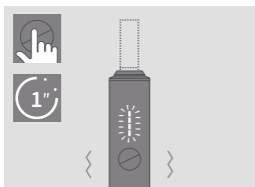

2. START HEATING

Press Button for at least 1 second until IQOS ILUMA ONE™ vibrates and Status Light(s) pulse(s).

Keep SMARTCORE STICK™ in position during the preheating.

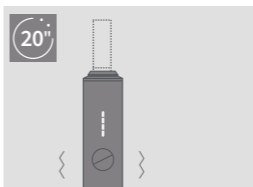

3. BEGIN USE

Start using once IQOS ILUMA ONE™ vibrates and Status Light(s) stay fixed.

How to use your IQOS ILUMA ONE™

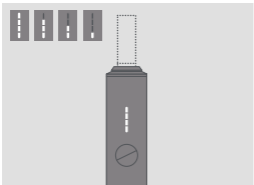

EXPERIENCE COUNTDOWN

During use, Status Light(s) indicate the remaining time.



4. NEARLY COMPLETE

To signal the last 30 seconds or last 2 puffs, IQOS ILUMA ONE™ will vibrate with one Light pulsing white.

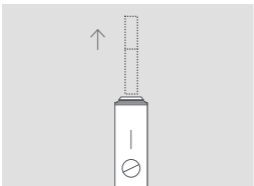

5. REMOVE SMARTCORE STICK™

Remove used SMARTCORE STICK™ and dispose as per Safety Warnings and Instructions.

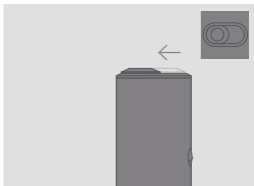

6. CLOSE

Slide to close.

Quick Tips

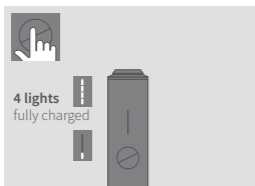

BATTERY STATUS

Short press Button, Status Lights will turn on to indicate battery level.

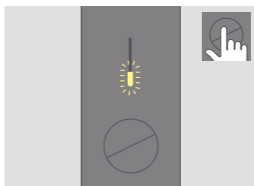

LIGHT BLINKS YELLOW

Battery depleted, need to charge.

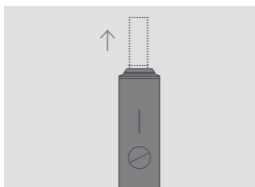

AUTOSTOP

During use, the experience will stop if the specifically designed tobacco stick is moved, or removed from the device.

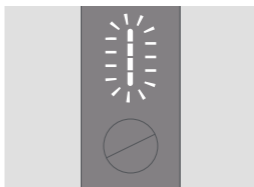

LIGHTS BLINK WHITE TWICE

IQOS ILUMA ONE™ is outside operating temperature range (0°C~40°C).

Quick Tips

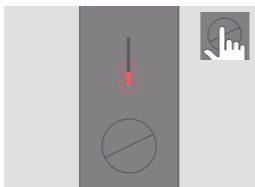

LIGHT BLINKS RED

Reset IQOS ILUMA ONE™.
If red light blinking persists,
contact Customer Care.

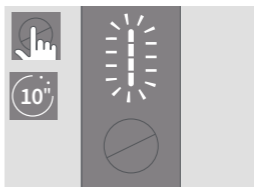

TO RESET

Press Button for 10 seconds
then release. All Status
Lights will turn OFF, and turn
ON, to confirm a RESET.