

IQOS ILUMA

User Guide

IQOS ILUMA™ Pocket Charger

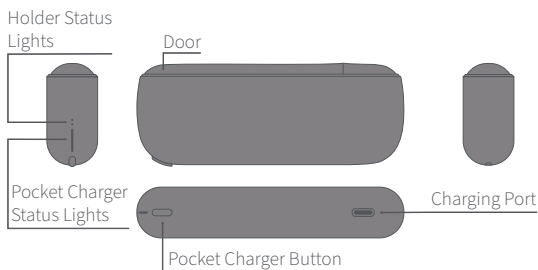

IQOS ILUMA™ Holder

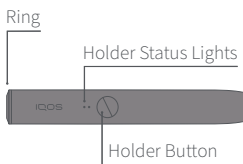

IQOS ILUMA™ is compatible only with SMARTCORE STICKS™

Charging

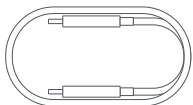

Charging Cable

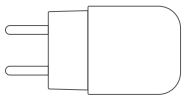

Power Adaptor

SUPPORT and SERVICES

For information on customer support and additional services for IQOS users, please visit

www.iqos.com/services

FEATURES AND SETTINGS

You can modify your IQOS experience according to your preferences with the IQOS App*.

Please register by scanning QR code or log in on www.iqos.com/iluma and follow the instructions.

* IQOS app may not be available in your country.

Getting Started

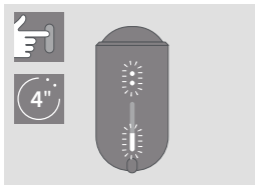

TURN ON

Press and hold Pocket Charger Button for 4 seconds, then release; Pocket Charger Status Lights and Holder Status Lights will turn on slowly.

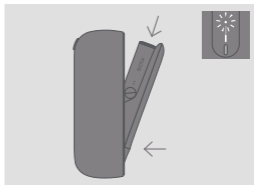

CHARGE HOLDER

Insert Holder into the Pocket Charger, to charge. Holder Status Light will show Holder battery level.

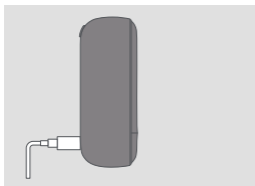

CHARGE POCKET CHARGER

Before first use, fully charge your device with Power Adaptor and Charging Cable. (approx. 135 min)

How to use your IQOS ILUMA™

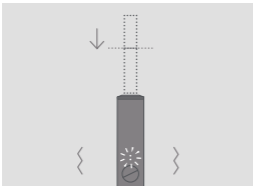

1. INSERT SMARTCORE STICK™

Insert the SMARTCORE STICK™ to the line on filter until Holder vibrates and Light(s) pulse(s).

Heating starts automatically, or by pressing button for 1 second.

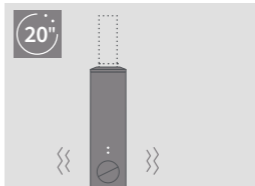

2. BEGIN USE

Start using once Holder vibrates and Lights stay fixed.



3. NEARLY COMPLETE

To signal the last 30 seconds or last 2 puffs, Holder will vibrate with Light(s) pulsing white.

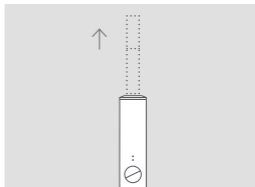

4. REMOVE SMARTCORE STICK™

Remove used SMARTCORE STICK™ and dispose as per Safety Warnings and Instructions.

How to use your IQOS ILUMA™

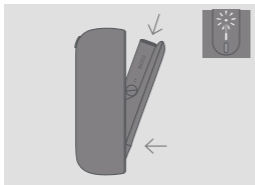

5. RECHARGE HOLDER

Insert the Holder in the Charger for recharging.

Quick Tips

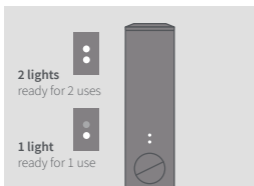

CHECK HOLDER STATUS

Tilt Holder towards you or short press button, Holder Lights indicate Holder battery level.

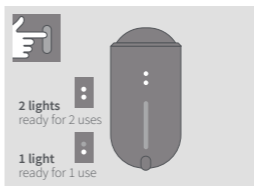

CHECK HOLDER STATUS ON THE POCKET CHARGER

Short press Pocket Charger Button. Holder Status Light will turn on.

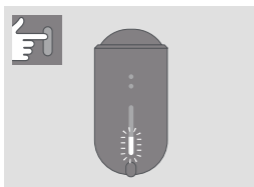

CHECK POCKET CHARGER STATUS

Short press Pocket Charger Button. Pocket Charger Status Lights will turn on to indicate battery level.



AUTOSTOP

During use, the experience will stop if the SMARTCORE STICK™ is moved, or removed from the Holder.

Quick Tips

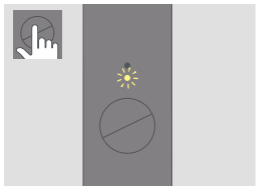

LIGHT BLINKS YELLOW

Battery depleted, need to charge.

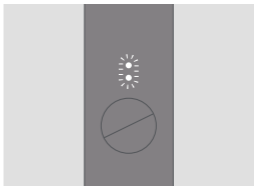

LIGHTS BLINK WHITE TWICE

IQOS ILUMA™ is outside operating temperature range (0°C~40°C).

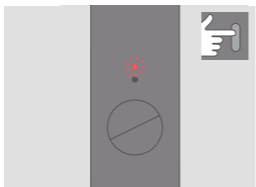

LIGHT BLINKS RED

Reset Pocket Charger.
If red light blinking persists,
contact Customer Care.

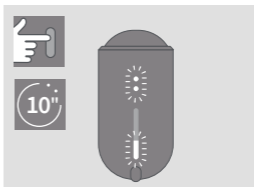

TO RESET

Place Holder in Pocket
Charger and press Button
for 10 seconds then release.
All Status Lights will turn OFF,
and turn ON, to confirm
a RESET.